

Proven Industrial Performance

CA and CB Hand Chain Hoists

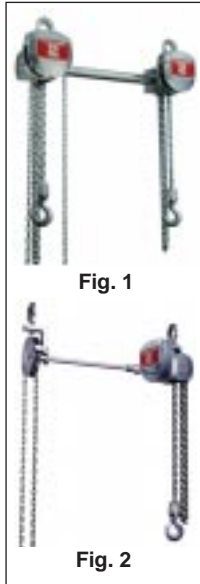
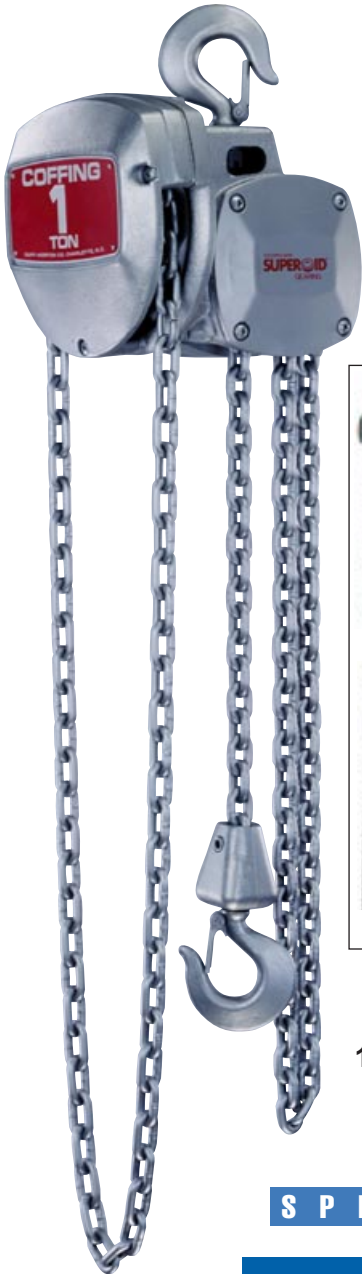

1/2 Ton - CA
1-12 Ton - CB
Made in USA

COFFING CA & CB Models - Hand chain hoists set the standard for performance and durability. The CB has exclusive right angle Superoid® gearing (see facing page) which provides smooth chain travel and requires little maintenance. The CB is ideal for industrial lifting applications.

- **CAPACITIES & LIFT** - Rated loads from 1/2 to 12 Tons. Standard 8-foot lift and 6-foot hand chain drop. Other lifts and hand chain drops available.
- **GOVERNMENT APPROVED** - All CB models except CA-1/2 meet MIL-H-904 Class 2 requirements, Type C, Style 1 or 2.
- **DURABLE** - Impact-resistant, permanent mold aluminum alloy housing provides extra strength and long service life.
- **EASY INSPECTION AND MAINTENANCE** - Easily dismantled with simple hand tools for routine inspection and maintenance.
- **OPTIONAL CAPACITY LIMITER** - Provided when specified at time of order at *no extra charge* (see facing page).
- **LOAD CONTROL** - Fully enclosed, self-adjusting, friction-type screw and disc load brake ensures positive load control.
- **TWIN HOOK (TH Models)** - Available for 1/2 to 3 Ton models. Useful for lifting long, bulky loads. Standard 3-foot space between hooks - for other spacing, consult factory. See Fig. 1
- **EXTENDED HAND WHEEL (EHW Models)** - Available for 1 1/2 to 3 Ton models. Useful for dipping applications or other situations where hoist must be operated from a distance. Standard 3-foot extension - for other lengths, consult factory. See Fig. 2
- **OPTIONS** - Bullard hooks, plated hooks, plated chain, stainless steel chain, spark-resistant features, and top clevis connection available - consult factory. Chain containers available, see page 35.
- **LIFETIME WARRANTY**

SPECIFICATIONS

CA and CB Hand Chain Hoists

| Capacity | | Model † | Capacity Limiter Model † | Strands of Load Chain | Minimum Headroom (In.) | Hand Chain Overhaul for 1 Ft. Lift (Ft.) | Average Pull to Lift Rated Load (Lbs.) | Net Weight (Lbs.) |
|----------|-------|----------|--------------------------|-----------------------|------------------------|--|--|-------------------|
| Lbs. | Tons | | | | | | | |
| 1000 | 1/2 | CA-1/2* | CA-1/2-CL* | 1 | 13 1/4 | 18 | 58 | 22 |
| 2000 | 1 | CB-1 | CB-1-CL | 1 | 13 3/8 | 38 | 58 | 38 |
| 3000 | 1 1/2 | CB-1 1/2 | CB-1 1/2-CL | 1 | 18 1/2 | 58 | 62 | 58 |
| 4000 | 2 | CB-2 | CB-2-CL | 1 | 18 1/2 | 58 | 83 | 58 |
| 6000 | 3 | CB-3 | CB-3-CL | 1 | 21 1/2 | 85 | 91 | 78 |
| 8000 | 4 | CB-4 | CB-4-CL | 2 | 25 1/4 | 116 | 85 | 98 |
| 10000 | 5 | CB-5 | CB-5-CL | 3 | 26 3/4 | 174 | 72 | 127 |
| 12000 | 6 | CB-6 | CB-6-CL | 3 | 26 3/4 | 174 | 87 | 127 |
| 16000 | 8 | CB-8 | CB-8-CL | 4 | 28 1/2 | 232 | 90 | 160 |
| 20000 | 10 | CB-10 | CB-10-CL | 4 | 31 | 340 | 83 | 212 |
| 24000 | 12 | CB-12 | CB-12-CL | 4 | 31 | 340 | 100 | 212 |

NOTE:

For complete dimensional data, refer to Coffing Dimensional Databook.

* Spur gear model.

† Specify TH for twin hook model or EHW for extended hand wheel model (ex. TH-1 or EHW-3).

CA, CB, CTH, TH, EHW & AT Features



Superoid® Gearing

Coffing's exclusive Superoid® gear transmission provides greater strength and durability with fewer wearing parts. This unique right angle gear drive involves only two rugged gears and engages four teeth at all times, providing smooth lifting power and spreading wear to decrease the need for maintenance.

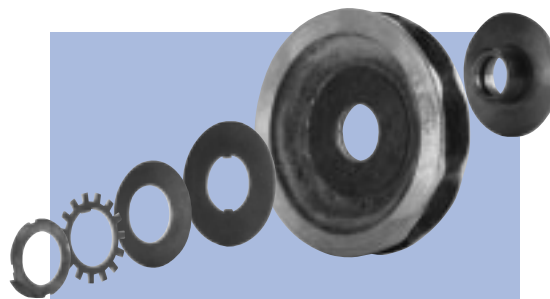

Capacity Limiter

Coffing's optional capacity limiter protects the operator, the load, and the hoist. Under severe overload conditions, the capacity limiter's clutch assembly automatically disengages the handwheel to prevent lifting of a dangerous overload. Removing the overload automatically restores the lifting capacity of the hoist. The capacity limiter is provided when specified at *no extra charge*.

CTH — Trolley Mounted Suspension

COFFING CTH Models - Featuring a CA or CB hoist integrally mounted to a CT trolley. The CTH is ideal for industrial lifting applications which require a trolley mounted hoist for horizontal movement of the load.

- **CAPACITIES & LIFT** - Rated loads from 1/2 to 6 Tons in plain or geared trolley models. Standard 8-foot lift and 6-foot hand chain drop, with other lifts and hand chain drops available.
- **REDUCED HEADROOM** - Lug-mounted trolley hoist design.
- **HOIST FEATURES** - Please refer to CA and CB information on previous page.
- **OPTIONS** - Capacity limiter available - provided when specified at time of order at *no extra charge*. Special trolley wheels, spark resistant features, and track clamps available — consult factory.



SPECIFICATIONS

CTH Trolley Mounted Hoists

| Capacity | | Model Number | Minimum Headroom (In.) | Hand Chain Overhaul for 1 Ft. Lift (Ft.) | Average Pull to Lift Rated Load (Lbs.) | Std. Beam Height (In.) | Minimum Radius Curve (In.) | Net Weight | |
|----------|-------|----------------|---------------------------------|--|--|------------------------|----------------------------|------------------|-------------------|
| Lbs. | Tons | | | | | | | Plain (P) (Lbs.) | Geared (G) (Lbs.) |
| 1000 | 1/2 | CTH-1/2-P(G)* | 14 | 18 | 58 | 6-18 | 48 | 64 | 71 |
| 2000 | 1 | CTH-1-P(G) | 14 ³ / ₈ | 38 | 58 | 6-18 | 48 | 80 | 87 |
| 3000 | 1 1/2 | CTH-1 1/2-P(G) | 18 ³ / ₄ | 58 | 62 | 6-18 | 48 | 100 | 107 |
| 4000 | 2 | CTH-2-P(G) | 18 ³ / ₄ | 58 | 83 | 6-18 | 48 | 100 | 107 |
| 6000 | 3 | CTH-3-P(G) | 20 | 85 | 91 | 6-18 | 48 | 135 | 142 |
| 8000 | 4 | CTH-4-P(G) | 27 ¹ / ₁₆ | 116 | 85 | 8-18 | ** | 221 | 228 |
| 10000 | 5 | CTH-5-P(G) | 27 ³ / ₄ | 174 | 72 | 8-18 | ** | 280 | 287 |
| 12000 | 6 | CTH-6-P(G) | 27 ³ / ₄ | 174 | 87 | 8-18 | ** | 280 | 287 |

NOTE:
For complete dimensional data, refer to Coffing Dimensional Databook.

NOTE: When ordering, specify "P" for plain trolley or "G" for geared trolley.

* Spur gear model.

** For Straight track only. Articulated model for 48 inch minimum radius curve track available. For wide flange and patented track applications, consult factory.

1/2 - 6 Ton

Made in USA

CA and CB 1/2 Ton - CA 1-12 Ton - CB (with or without Capacity Limiter)

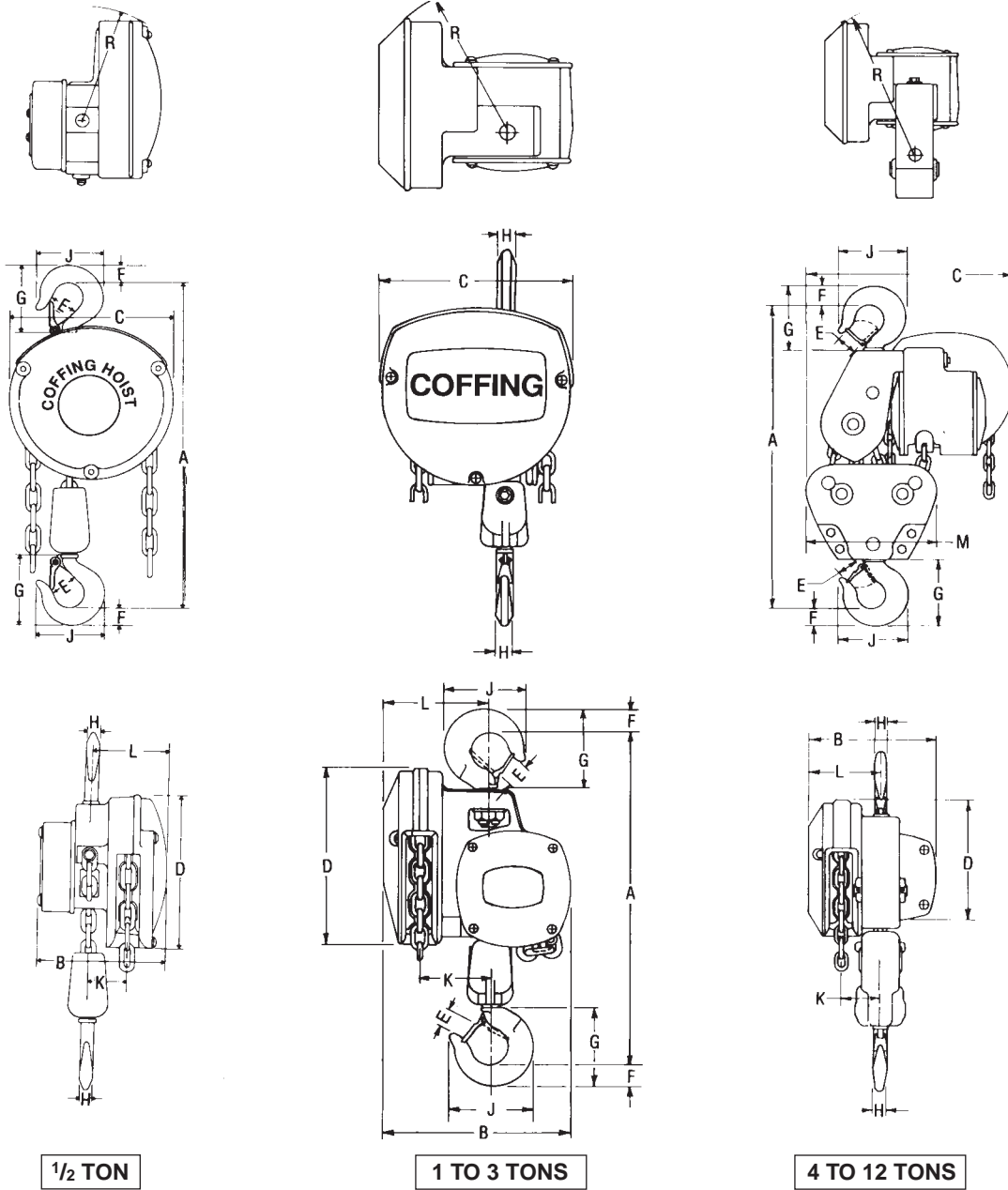

1/2 TON

1 TO 3 TONS

4 TO 12 TONS

Dimensions

| Model No. | Rated Load | | A | B | C | D | E | F | G | H | J | K | L | M | R |
|----------------------------------|------------|-------------------------------|--------------------------------|--------------------------------|---------------------------------|---------------------------------|---------------------------------|----------------------------------|---------------------------------|---------------------------------|---------------------------------|---------------------------------|---------------------------------|--------------------------------|--------------------------------|
| | (Lbs.) | (Ton) | | | | | | | | | | | | | |
| CA-1/2 | 1000 | 1/2 | 13 ¹ / ₄ | 6 ¹ / ₂ | 8 ¹ / ₄ | 8 | 1 | 1 | 3 ¹¹ / ₁₆ | 3/4 | 3 ⁵ / ₈ | 2 | 3 ¹⁵ / ₁₆ | — | 6 ¹ / ₈ |
| CB-1 | 2000 | 1 | 13 ³ / ₈ | 9 | 8 ⁵ / ₁₆ | 8 | 1 | 1 | 3 ¹¹ / ₁₆ | 3/4 | 3 ⁵ / ₈ | 3 ³ / ₄ | 5 ¹ / ₈ | — | 7 ¹ / ₈ |
| CB-1 ¹ / ₂ | 3000 | 1 ¹ / ₂ | 18 ¹ / ₂ | 10 ⁵ / ₈ | 10 ³ / ₄ | 10 ³ / ₁₆ | 11 ¹ / ₃₂ | 17 ¹ / ₁₆ | 5 ⁷ / ₃₂ | 1 ¹ / ₈ | 4 ¹⁵ / ₁₆ | 4 ³ / ₁₆ | 6 | — | 9 |
| CB-2 | 4000 | 2 | 18 ¹ / ₂ | 10 ⁵ / ₈ | 10 ³ / ₄ | 10 ³ / ₁₆ | 11 ¹ / ₃₂ | 17 ¹ / ₁₆ | 5 ⁷ / ₃₂ | 1 ¹ / ₈ | 4 ¹⁵ / ₁₆ | 4 ³ / ₁₆ | 6 | — | 9 |
| CB-3 | 6000 | 3 | 21 ¹ / ₂ | 12 | 10 ³ / ₄ | 10 ³ / ₁₆ | 11 ¹ / ₁₆ | 11 ¹³ / ₁₆ | 6 ⁹ / ₁₆ | 1 ³ / ₈ | 6 ¹ / ₂ | 4 ¹¹ / ₁₆ | 6 ¹ / ₂ | — | 9 ³ / ₄ |
| CB-4 | 8000 | 4 | 25 ¹ / ₄ | 10 ⁵ / ₈ | 13 ¹ / ₁₆ | 10 ³ / ₁₆ | 11 ¹ / ₁₆ | 11 ¹³ / ₁₆ | 6 ⁹ / ₁₆ | 1 ³ / ₈ | 6 ¹ / ₂ | 4 ³ / ₁₆ | 6 | 5 ¹ / ₈ | 11 ¹ / ₄ |
| CB-5 | 10000 | 5 | 26 ³ / ₄ | 10 ⁵ / ₈ | 15 | 10 ³ / ₁₆ | 11 ¹ / ₁₆ | 11 ¹³ / ₁₆ | 6 ⁹ / ₁₆ | 1 ³ / ₈ | 6 ¹ / ₂ | 4 ³ / ₁₆ | 6 | 5 ⁵ / ₈ | 12 |
| CB-6 | 12000 | 6 | 26 ³ / ₄ | 10 ⁵ / ₈ | 15 | 10 ³ / ₁₆ | 11 ¹ / ₁₆ | 11 ¹³ / ₁₆ | 6 ⁹ / ₁₆ | 1 ³ / ₈ | 6 ¹ / ₂ | 4 ³ / ₁₆ | 6 | 5 ⁵ / ₈ | 12 |
| CB-8 | 16000 | 8 | 28 ¹ / ₂ | 10 ⁵ / ₈ | 16 ⁷ / ₁₆ | 10 ³ / ₁₆ | 2 ¹ / ₁₆ | 2 ¹ / ₄ | 8 ¹ / ₈ | 1 ⁵ / ₈ | 7 ⁹ / ₁₆ | 4 ³ / ₁₆ | 6 | 10 ¹ / ₂ | 12 ³ / ₈ |
| CB-10 | 20000 | 10 | 31 | 12 | 18 ¹ / ₈ | 11 ¹ / ₈ | 2 ¹ / ₄ | 2 ⁵ / ₈ | 9 ¹ / ₁₆ | 1 ¹⁵ / ₁₆ | 8 ¹¹ / ₁₆ | 4 ¹¹ / ₁₆ | 6 ¹ / ₂ | 12 | 13 ⁵ / ₈ |
| CB-12 | 24000 | 12 | 31 | 12 | 18 ¹ / ₈ | 11 ¹ / ₈ | 2 ¹ / ₄ | 2 ⁵ / ₈ | 9 ¹ / ₁₆ | 1 ¹⁵ / ₁₆ | 8 ¹¹ / ₁₆ | 4 ¹¹ / ₁₆ | 6 ¹ / ₂ | 12 | 13 ⁵ / ₈ |

Note: Where clearance dimensions are critical, request certified prints. Dimensions are in inches unless otherwise indicated.

CTH Trolley Mounted Suspension

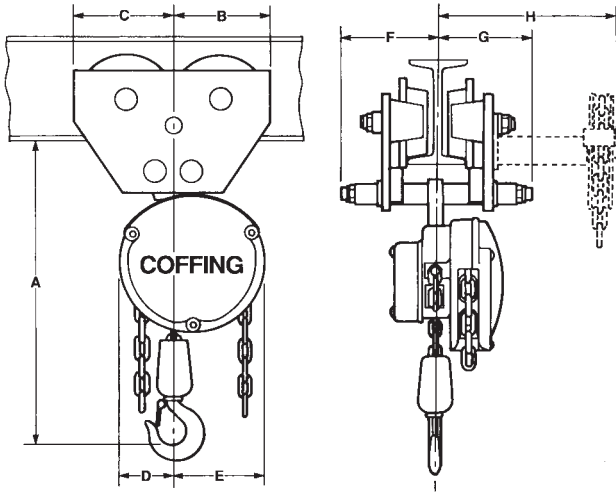

CTH-1/2 TON

Authorized Sales & Service
J. HERBERT CORPORATION
Call 1-800-255-0588
407-846-0588 Fax: 846-1066
info@jherbertcorp.com

Visit us online:
www.jherbertcorp.com

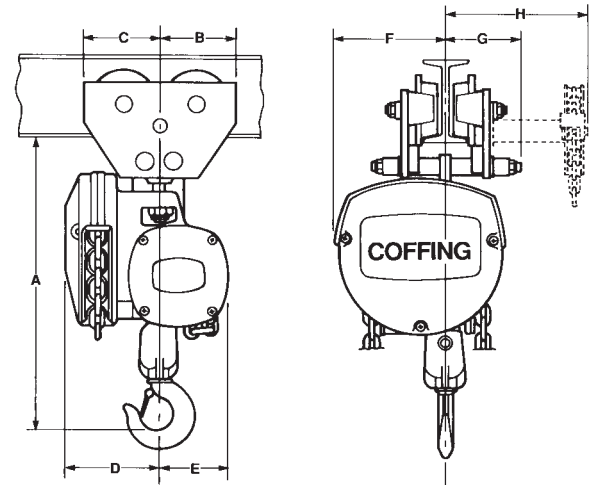

CTH-1 TON TO 3 TONS

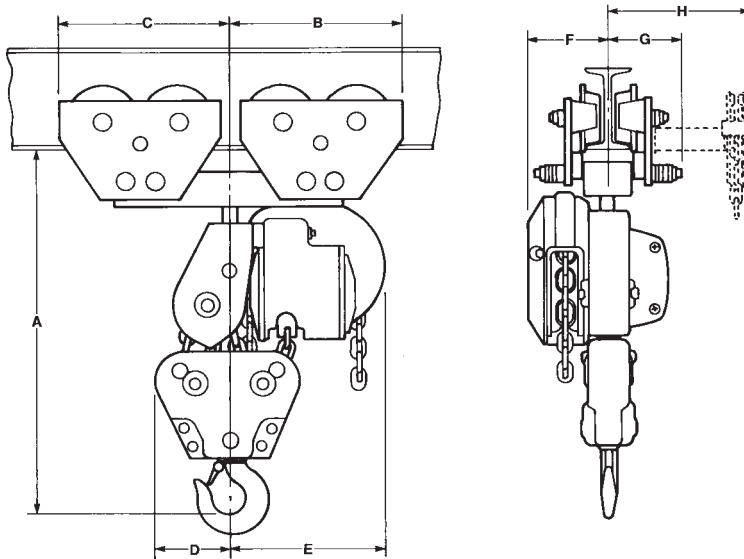

CTH-4 TON TO 6 TONS (Straight Track Only)

All dimensions are based on 6" x 12.5# American Standard I-Beam for 1/2 thru 3 Ton models.

All dimensions are based on 8" x 18.4# American Standard I-Beam for 4 thru 6 Ton models.

4-Ft. Minimum Radius on 1/2 thru 3 Ton models.

Dimensions are in inches unless otherwise indicated.

Dimensions

| Model Number | A | B | C | D | E | F | G | H |
|--------------------------------------|---------------------------------|--------------------------------|--------------------------------|-------------------------------|---------------------------------|---------------------------------|-------------------------------|-------------------------------|
| CTH1/2 | 14 | 6 ¹ / ₄ | 6 ¹ / ₄ | 2 ⁷ / ₈ | 5 ¹ / ₄ | 5 ³ / ₈ | 5 ³ / ₈ | 7 ⁷ / ₈ |
| CTH1 | 14 ³ / ₈ | 6 ¹ / ₄ | 6 ¹ / ₄ | 5 ¹ / ₈ | 3 ⁷ / ₈ | 5 ³ / ₈ | 5 ³ / ₈ | 7 ⁷ / ₈ |
| CTH1 ¹ / ₂ & 2 | 18 ³ / ₄ | 6 ¹ / ₄ | 6 ¹ / ₄ | 6 | 4 ⁵ / ₈ | 6 ¹⁵ / ₁₆ | 5 ³ / ₈ | 7 ⁷ / ₈ |
| CTH3 | 20 | 6 ³ / ₈ | 6 ³ / ₈ | 6 ¹ / ₂ | 5 ¹ / ₂ | 7 ¹ / ₄ | 5 ³ / ₈ | 7 ⁷ / ₈ |
| CTH4 | 27 ¹ / ₁₆ | 12 ³ / ₄ | 12 ³ / ₄ | 3 | 10 ¹ / ₁₆ | 6 | 5 ³ / ₈ | 8 ¹ / ₄ |
| CTH5 & 6 | 27 ³ / ₄ | 12 ⁷ / ₈ | 12 ⁷ / ₈ | 4 ³ / ₈ | 10 ⁵ / ₈ | 6 | 5 ³ / ₈ | 8 ¹ / ₄ |

Note: Where clearance dimensions are critical, request certified prints.